

Type VA 721

3-way solenoid valve
direct actuated, NC
(normally closed)

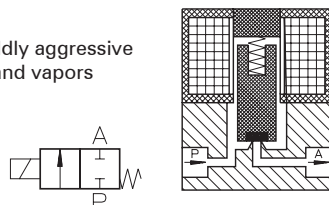

Application
Neutral and mildly aggressive
liquids, gases and vapors



Type/ Order No.	Orifice [mm]	Port size	Pressure range [bar]		kv-value [m³/h]	Weight [kg]
			AC	DC		
VA 721-011	1,0	G 1/8	0 - 20	0 - 12	0,03	0,190
VA 721-014	1,6	G 1/8	0 - 16	0 - 10	0,06	0,190
VA 721-017	2,2	G 1/8	0 - 10	0 - 6	0,11	0,190

Sealing material: **E** (EPDM) **V** (FPM) **Z** (FFPM)

Body material: Stainless steel (1.4305)
 Inner parts: Stainless steel (1.4305)
 Mounting direction: Free, preferred upwards
 Max. ambient temp.: 50 °C
 Viscosity of the medium: max. 21 mm²/s (3 °E)
 Static pressure: max. 30 bar
 Standard voltage: DC: 24, 12 V
 AC: 230 V, 115 V, 42 V,
 24 V, 12 V (50 or 60 Hz)

Power consumption: 5 VA / 5 W
 Voltage tolerance: -15%... +10%
 Duty cycle: 100 %
 Operating frequency: max. 1000/min
 Degree of Protection: IP 54 (EN 60529)
 Internal circuit for AC: Y

Other configurations upon request



accessories

	connection bush	hose nozzle	plug
NBR	530 000 544	530 000 545	530 000 546
FPM	530 001 123	530 000 723	530 001 124
EPDM	530 001 125	530 001 126	530 001 127

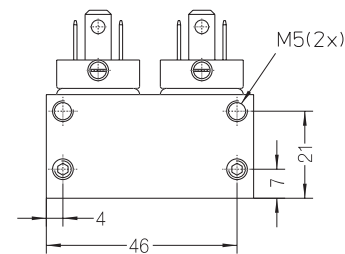

The right to modification is reserved

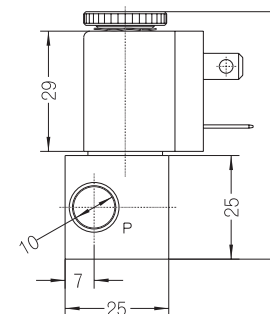
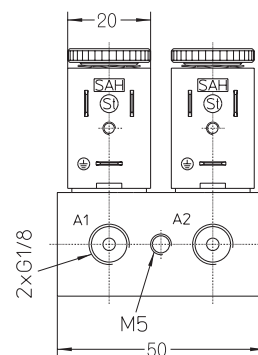

Dimensions in mm